



## 1/14 Gilbert Street, Dover Heights

4  3  3 

### Pinnacle of Sydney Harbourside Living

This exceptional four-bedroom family residence, with three well-appointed bathrooms, presents a rare opportunity to secure a prime property in one of the city's most sought-after locales. Designed with families and entertainers in mind, this home boasts an impressive 536 square metres of land, complete with an expansive, sun-soaked garden perfect for alfresco dining and outdoor enjoyment.

With picturesque views of the iconic Sydney Harbour and city skyline, this home is not only a comfortable living space but also a visual spectacle. The residence includes a full suite of features:

With the option to acquire the property furnished, you can start your new chapter with ease. This is an exceptional offering that delivers both luxury and convenience, setting the scene for an enviable lifestyle.

LEASED

View  
As advertised or  
By appointment

Aiman Konsowa  
0412 403 336

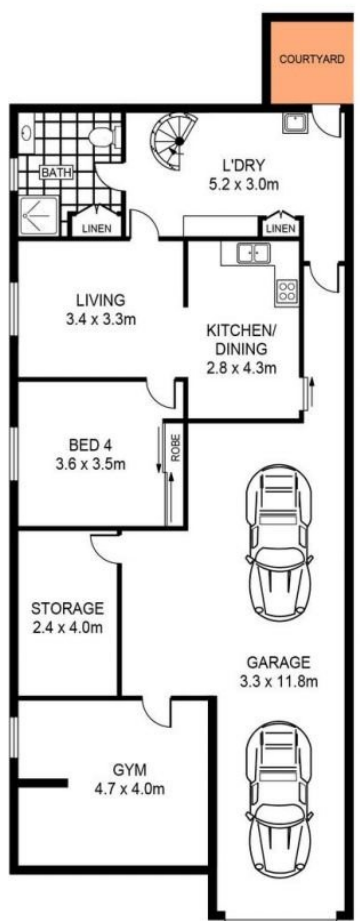

LOWER GROUND LEVEL

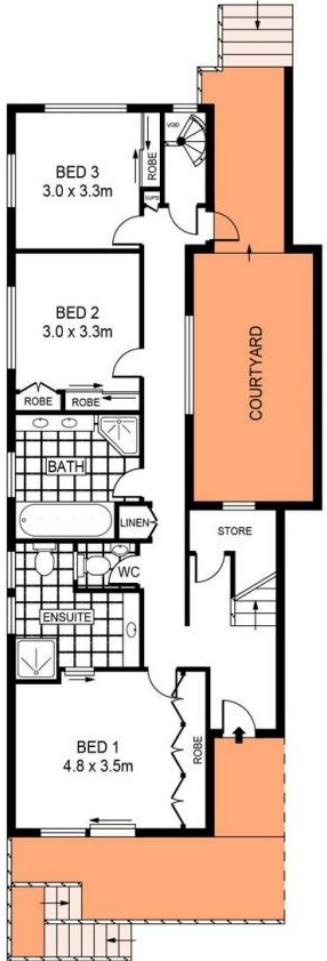

GROUND LEVEL

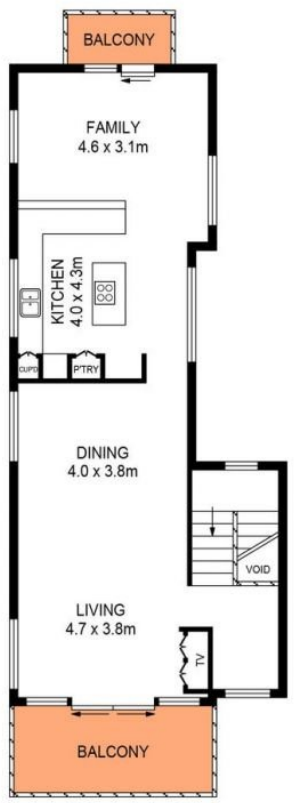

LEVEL ONE

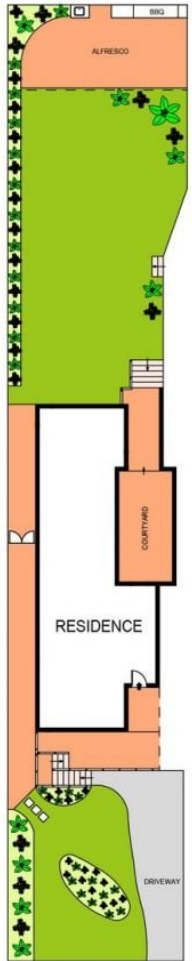

SITE PLAN  
(NOT TO SCALE)



SCALE (METRES)

PLANS SHOWN ONLY INDICATIVE OF LAYOUT. DIMENSIONS ARE APPROXIMATE.  
Ref. No: 83458

1/14 GILBERT STREET

DOVER HEIGHTS